

Installation Diagram

Two installation methods, as follows.

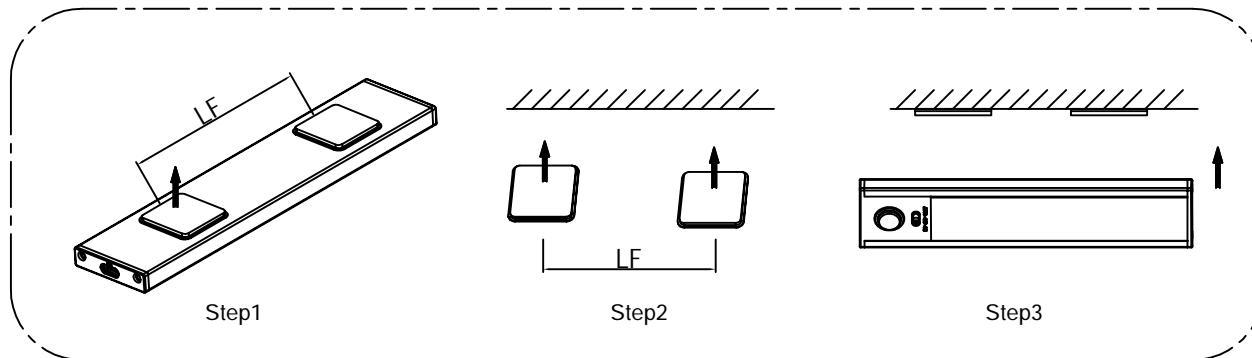

- (1) Fix the light with 3M adhesive: 1. Unscrew the mounting cover 2. Attach 3M adhesive to the surface of the mounting cover and bond it to the position where it needs to be installed. 3. Screw on the main body to fix the light

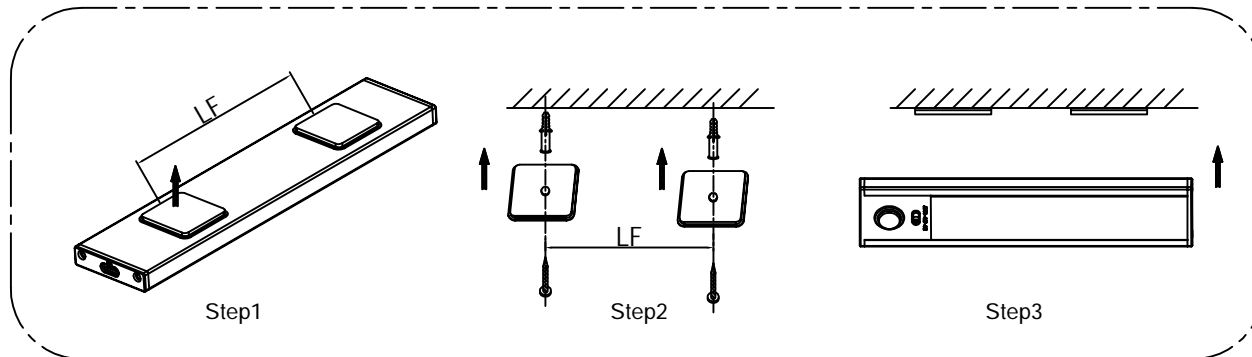

- (2) Fix the light with screw spike: 1. Unscrew the mounting cover 2. Install the expansion tube at the position to be installed, and the screw spike is fixed to the expansion tube through the mounting cover 3. Screw on the main body to fix the light